

The logo for Melvyn Danes Estate Agents is located in the top right corner. It consists of a yellow oval with a green border. Inside the oval, the word "melvyn" is written in a small, black, sans-serif font. Below it, the word "Danes" is written in a large, bold, green, sans-serif font. Underneath "Danes", the words "ESTATE AGENTS" are written in a smaller, black, sans-serif font.

melvyn  
**Danes**  
ESTATE AGENTS

A circular "For Sale" sign is positioned in the front garden. The sign is yellow with a red border and features the Melvyn Danes logo and contact information. The text on the sign includes "melvyn Danes", the phone number "0121 742 2123", the website "melvyn-danes.co.uk", and "FOR SALE" in red letters at the bottom.

melvyn  
**Danes**  
0121 742 2123  
melvyn-danes.co.uk  
FOR SALE

Olorenshaw Road

Sheldon

Offers Over £340,000

## Description

A larger style, extended semi detached house on a sought after road in Sheldon with NO ONWARD CHAIN.

This lovely property has so much potential to extend further (STPP) and is a complete blank canvas to make your own.

In a superb location, near to a good range of shops, schools, facilities and transport links and comprising:-

Storm porch, entrance hall, dining room, extended lounge, extended kitchen, utility and guest WC to the ground floor. Upstairs there are four bedrooms, a re fitted shower room and separate WC. Further benefiting from central heating, double glazing, drive, integral garage and gardens to the front and rear.



# Accommodation

## Drive

## Front Garden

## Storm Porch

6'1 x 1'11 (1.85m x 0.58m)

## Entrance Hall

5'10 x 13'1 (1.78m x 3.99m)

## Dining Room

10'11 max x 14'7 to bay (3.33m max x 4.45m to bay)

## Extended Lounge

9'10 max x 16'6 max (3.00m max x 5.03m max)

## Extended Kitchen

17'6 max x 6'5 max (5.33m max x 1.96m max)

## Utility

9'4 max x 2'7 min (2.84m max x 0.79m min)

## Guest WC

4'1 x 2'6 (1.24m x 0.76m)

## Integral Garage

9'8 x 10'4 min (2.95m x 3.15m min)

## Landing

7'11 max x 15'4 max (2.41m max x 4.67m max)

## Bedroom One

10'6 max x 15'3 to bay (3.20m max x 4.65m to bay)

## Bedroom Two

9'10 x 10'5 (3.00m x 3.18m)

## Bedroom Three

9'7 x 9'10 (2.92m x 3.00m)

## Bedroom Four

6'5 x 8'4 (1.96m x 2.54m)

## Re Fitted Shower Room

6'9 x 5'6 (2.06m x 1.68m)

## Separate WC

2'9 x 3'7 (0.84m x 1.09m)

## Rear Garden

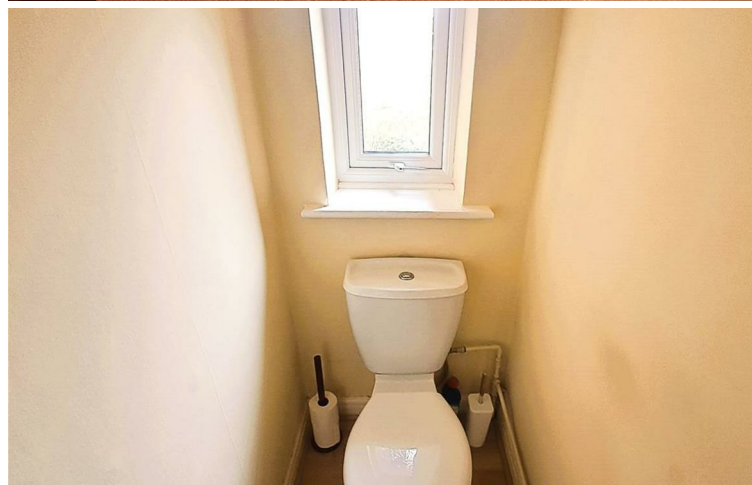

TERMURE: We are advised that the property is .....

BROADBAND: We understand that the standard broadband download speed at the property is around xx Mbps, however please note that results will vary depending on the time a speed test is carried out. The estimated fastest download speed currently achievable for the property post code area is around xx Mbps. Data taken from checker.ofcom.org.uk on xx/xx/xxxx. Actual service availability at the property or speeds received may be different.

MOBILE: We understand that the property is likely to have/has limited current mobile coverage (data taken from checker.ofcom.org.uk on xx/xx/xxxx). Please note that actual services available may be different depending on the particular circumstances, precise location and network outages.

VIEWING: By appointment only with the office on the number below.

These particulars are for general guidance only and are based on information supplied and approved by the seller. Complete accuracy cannot be guaranteed and may be subject to errors and/or omissions. They do not constitute representations of fact or form part of any offer or contract. Any Prospective Purchaser should obtain verification of all legal and factual matters and information from their Solicitor. Licensed Conveyancer or Surveyors as appropriate. The agent has not sought to verify the legal title of the property and the buyers must obtain verification from their solicitor. Photographs are provided for illustrative purposes only and the items shown in these are not necessarily included in the sale, unless specifically stated. The agent has not tested any apparatus, equipment, fixtures, fittings or services mentioned and do not by these Particulars or otherwise verify or warrant that they are in working order.

MONEY LAUNDERING REGULATIONS: Under anti-money laundering legislation, we are obliged to confirm the identity of individuals and companies and the beneficial owners of organisations and trusts before accepting new instructions, and to review this from time to time. To avoid the need to request detailed identity information from vendors and intending purchasers, we may use approved external services which review publicly available information on companies and individuals. However, should those checks, for any reason, fail adequately to confirm identity, we may write to you to ask for identification evidence. If you do not provide satisfactory evidence or information within a reasonable time, we may have to stop acting for you and we would ask for your co-operation in order that there will be no delay in agreeing a sale. Any purchaser who has a provisional offer accepted via this company will be liable to pay a purchase administration fee of £25 inclusive of VAT to cover these checks.

REFERRAL FEES: We may refer you to recommended providers of ancillary services such as Conveyancing, Financial Services and Surveying. We may receive a commission payment fee or other benefit (known as a referral fee) for recommending their services. You are not under any obligation to use the services of the recommended provider.

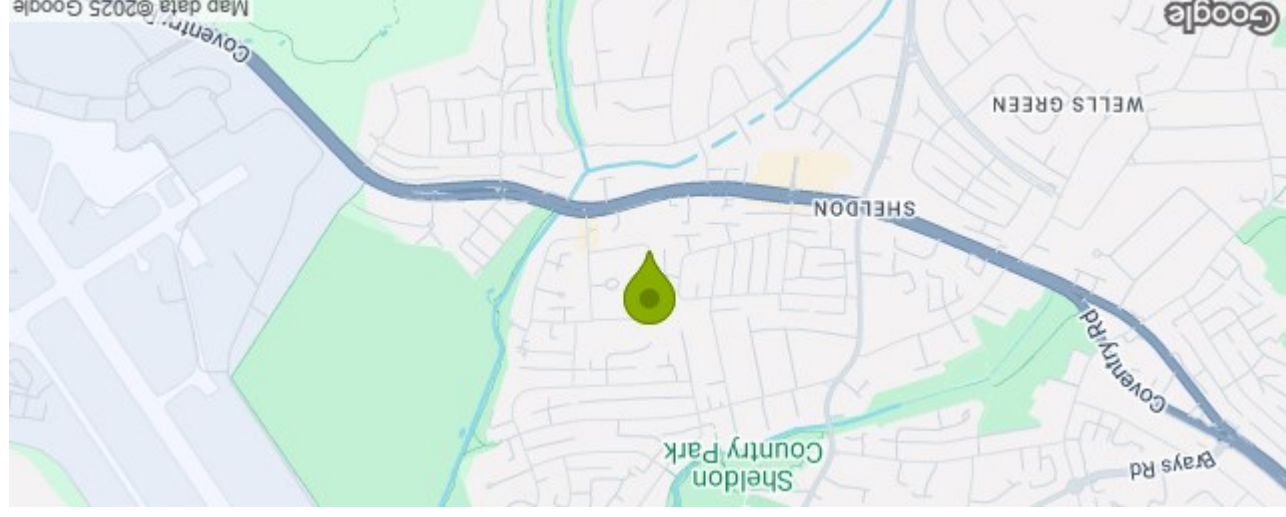

### 37 Olorenshaw Road Sheldon Birmingham B26 3NE Council Tax Band: D

Energy Efficiency Rating	
Very energy efficient - lower running costs	Potential
(92 plus) A	Current
(81-91) B	72
(69-80) C	54
(55-68) D	
(39-54) E	
(21-38) F	
(1-20) G	
Not energy efficient - higher running costs	
EU Directive 2002/91/EC	

Total area: approx. 118.1 sq. metres (1271.5 sq. feet)

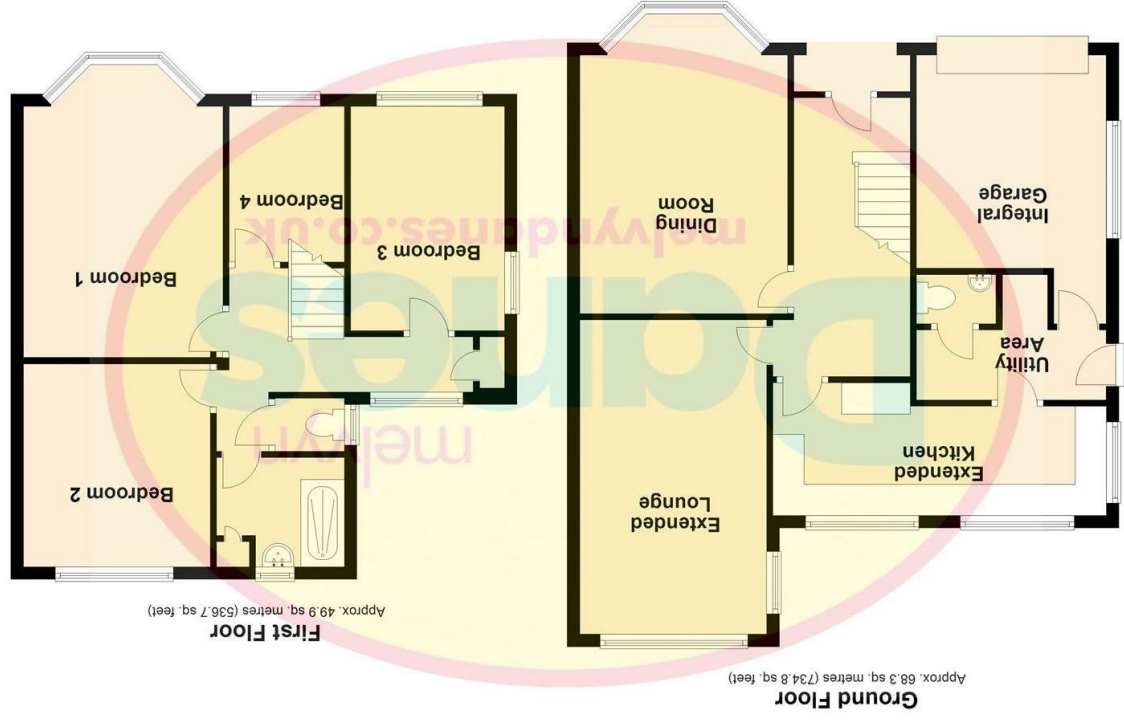

Please note that all measurements and floor plans are approximate and quoted for general guidance only and whilst every attempt has been made to ensure accuracy, they must not be relied on and do not form part of any contract.